

The North, South, and West walls are white drywall; the entire East Wall is brick, with two vertical windows that measure 2-ft-wide by 10-ft-tall.

Equipment:

- Ceiling mounted lighting grid, with programmable lighting board.
- Three mountable digital projectors: BenQ MH750, BenQ EH600, and Optoma GT2100HDR short-throw.
- CD and DVD players
- Macintosh laptop, software includes Pro Tools and QLab.
- 4 Mackie speakers with ceiling mounts
- Various audio output devices

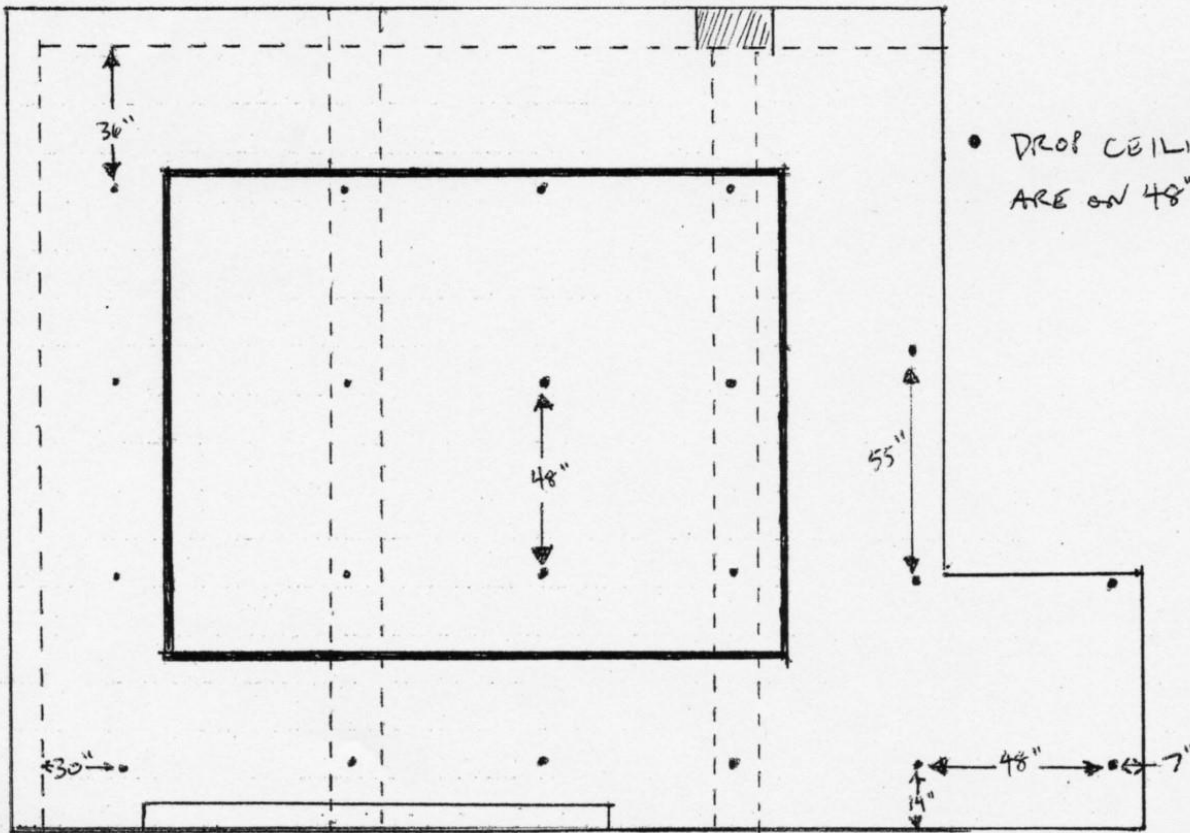

• DROP CEILING HOOKS
ARE ON 48" GRID

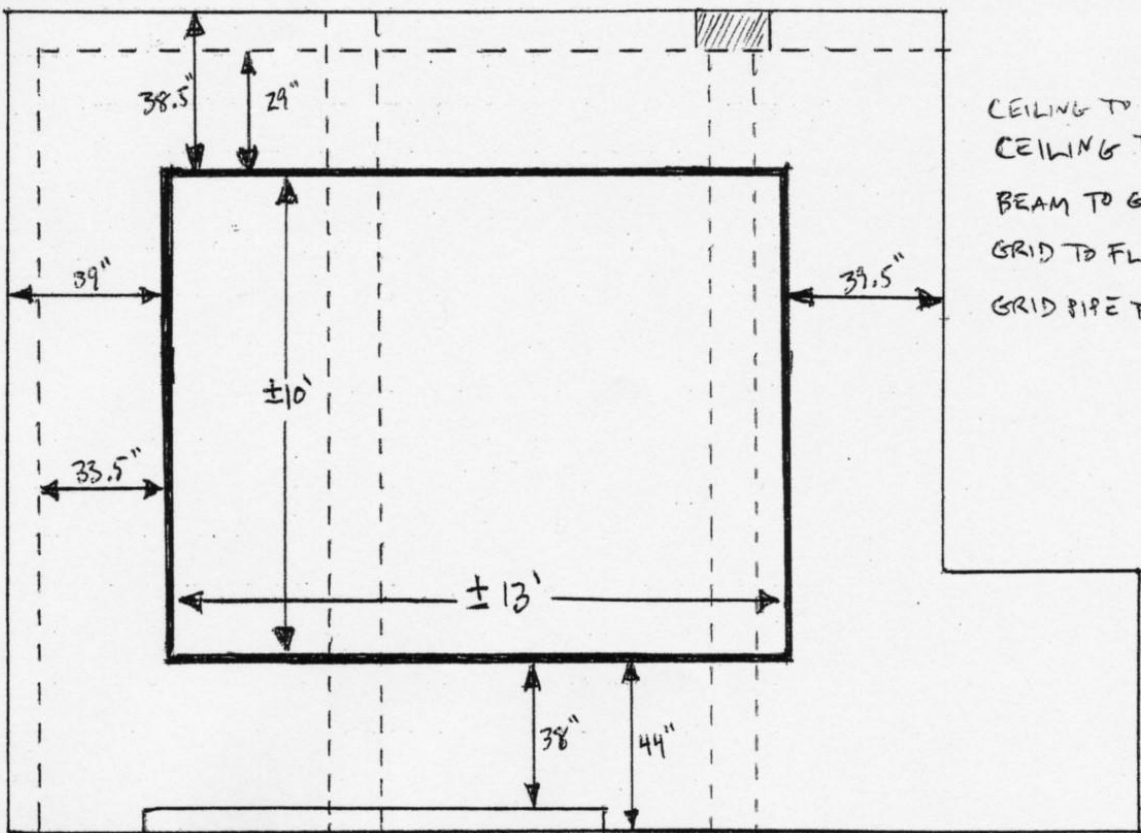

CEILING TO FLOOR = 16' 7"
 CEILING TO GRID = ± 42"
 BEAM TO GRID = ± 25"
 GRID TO FLOOR = ± 13"
 GRID PIPE DIAM. = 1 5/8"